

PARKROYAL on Pickering
- Singapore

3 Upper Pickering Street
Singapore 058289

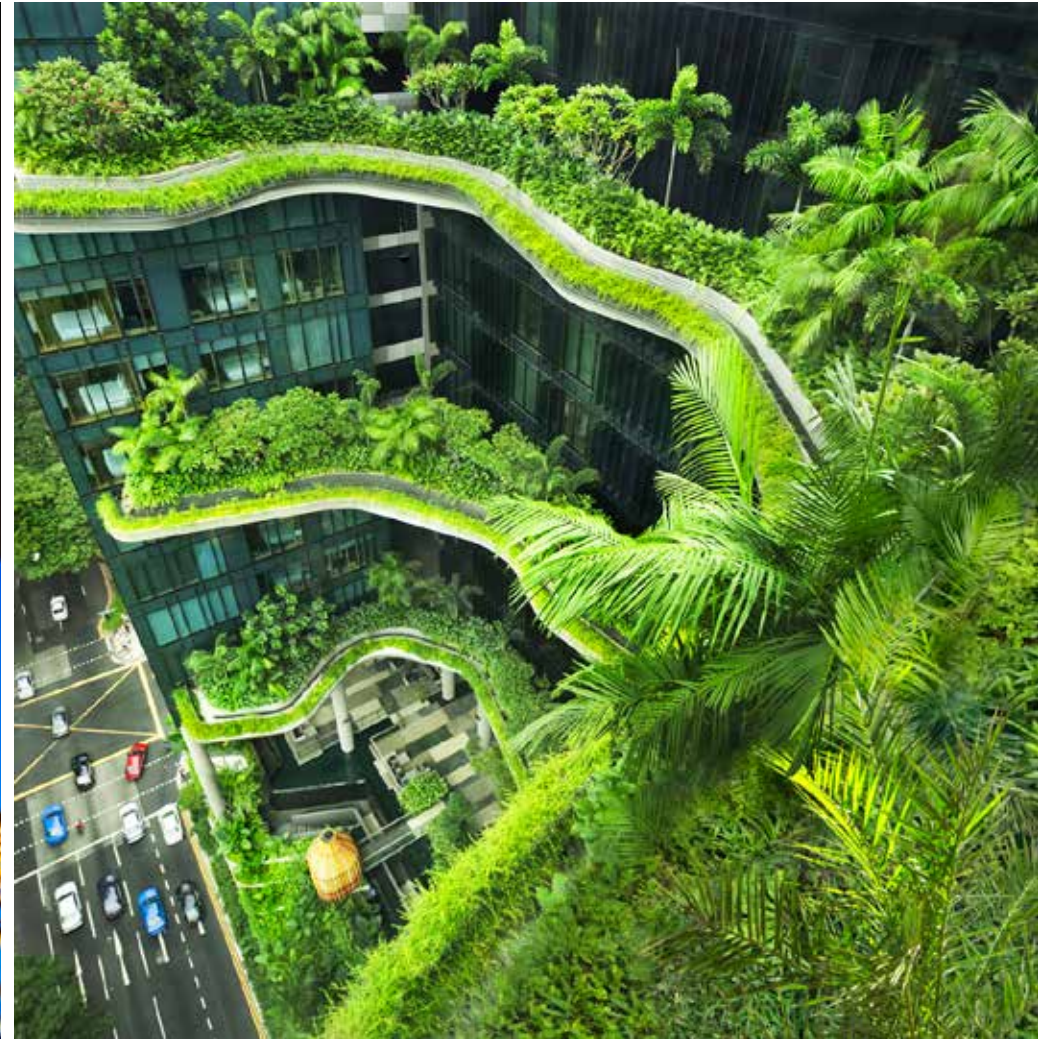







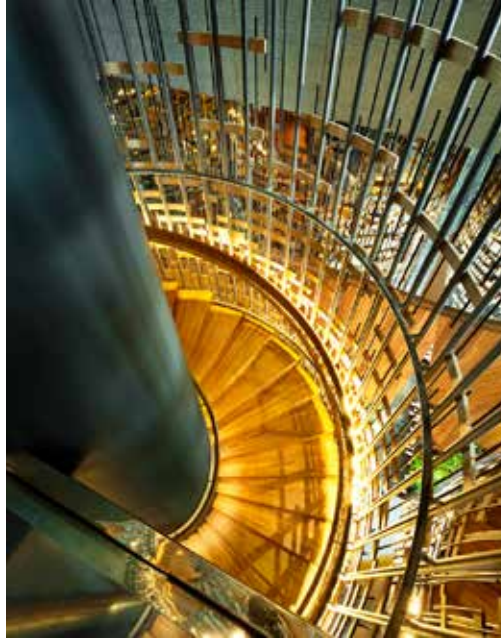

Architect's Statement

Designed as a hotel and office in a garden, the project at Upper Pickering Street is a study of how we can not only conserve our greenery in a built-up high-rise city centre but multiply it in a manner that is architecturally striking, integrated and sustainable. Located in central Singapore, the site is at a junction between the CBD and the colorful districts of Chinatown and Clarke Quay, and faces Hong Lim Park.

A contoured podium responds to the street scale and is sculpted to form dramatic outdoor plazas, gardens and terraces which flow seamlessly into the interiors. Greenery from the park is drawn up the building in the form of lushly planted openings, crevasses, gullies and waterfalls, which also conceal above ground carparking, thus creating an attractive urban element.

Project Dates

Design Inception – December 2007
Start of Construction – December 2009
Completion – January 2013

-
PARKROYAL on Pickering
Copyright © WOHA